

Shree VasuPujya Avenue

Luxury 3.5 BHK Residences

Welcome to VasuPujya

Discover premium urban living at Shree VasuPujya Avenue,
a boutique residential development offering 3.5 BHK homes
thoughtfully designed for elegance and function.





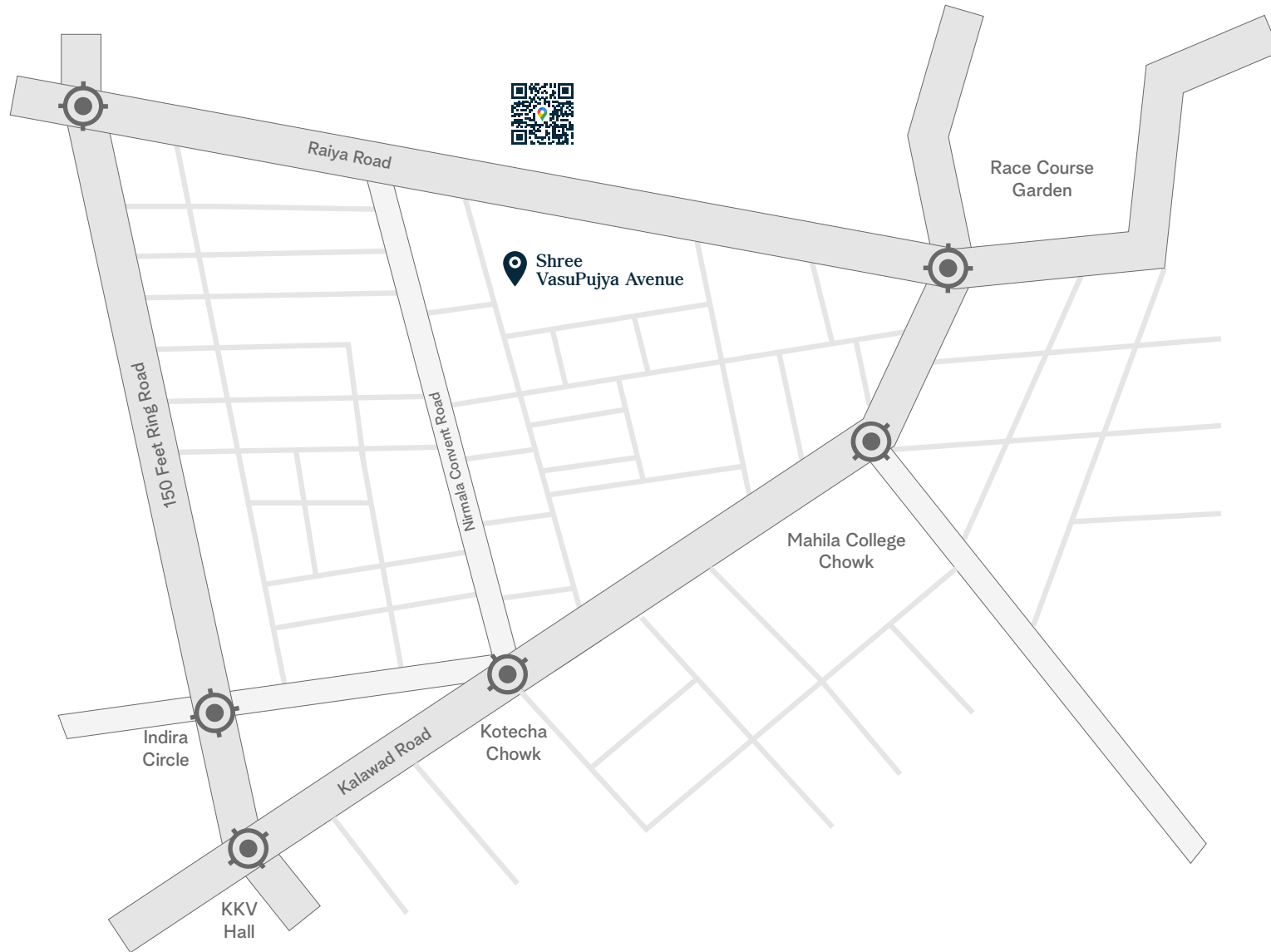

4-Side Open Flats

Designed for optimal light and ventilation. Enjoy a brighter, more breathable living space all year round.

Prime Location

Situated in Rajkot's core near schools and temples. Daily essentials and lifestyle needs are just minutes away.

Amenities



Stylish elevation



Solar water system



Fire safety system



CCTV surveillance



EV charging point



Watchman room



SS lift with auto door



Weather-proof paint



Power backup (general)

Modern Architecture

Elegant elevation with smart spatial planning. Built to blend visual appeal with structural strength.

Exclusive Opportunities

Every feature chosen for comfort and ease. Live smart with security, sustainability, and style.



Contact :

[9586820577](tel:9586820577)

Yash Rathod ~ 95868 20577

Address :

Gulab Nagar, Behind Swaminarayan Temple,
Kalawad Road, Rajkot



1st to 5th Typical Floor Plan

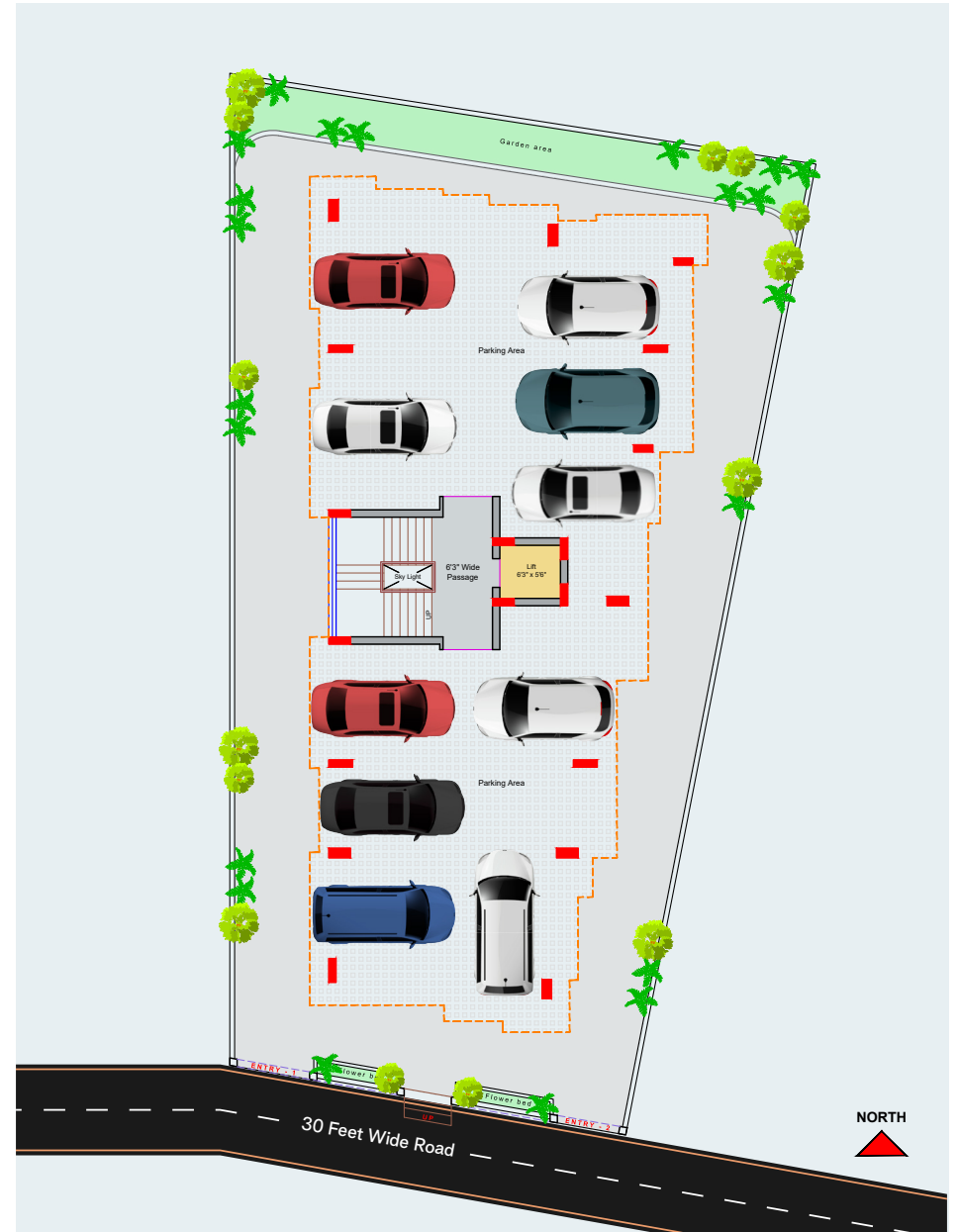

Parking Plan (Ground Floor)

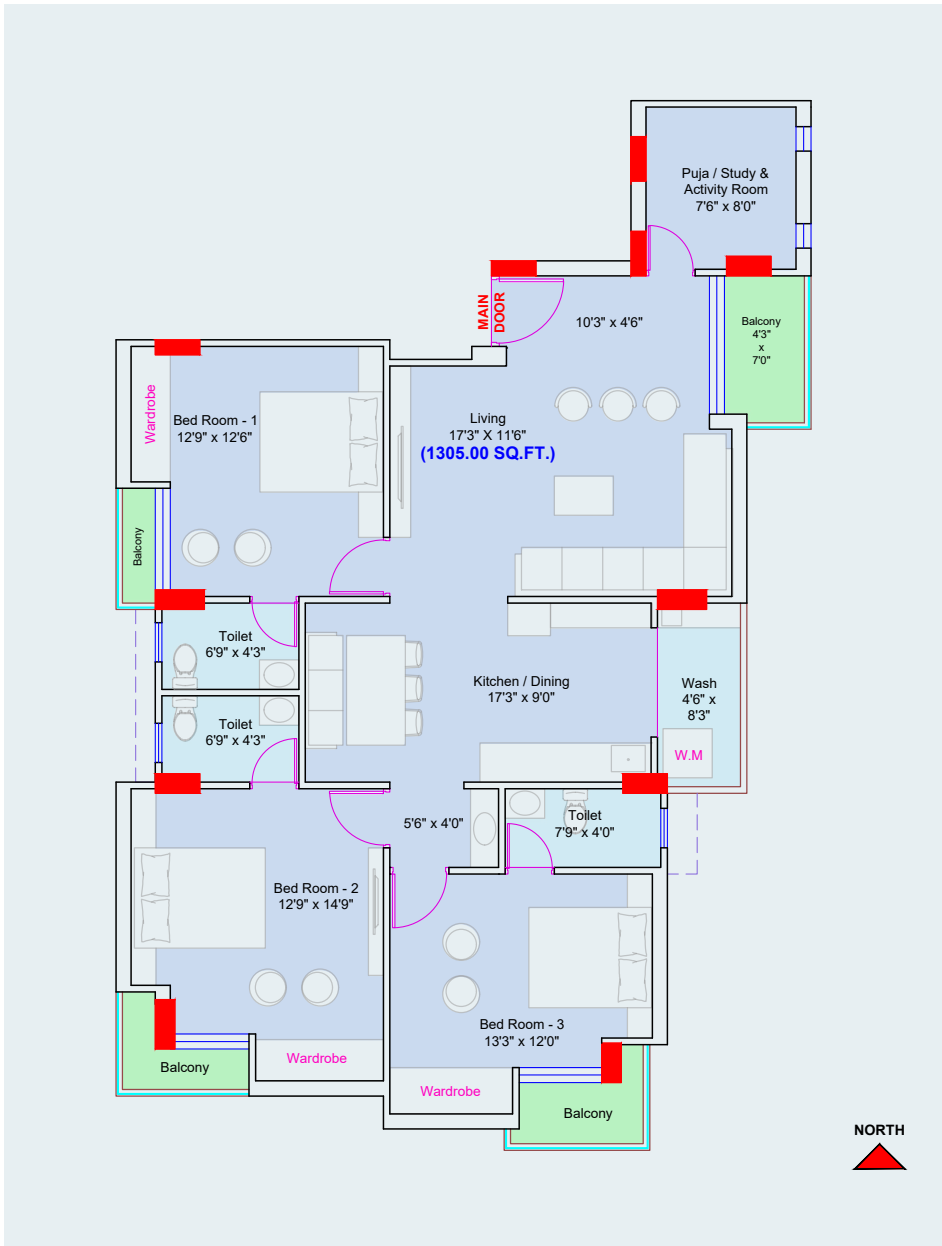

Front Side of Road Planning (Type - A) **1305.00 sq.ft.**

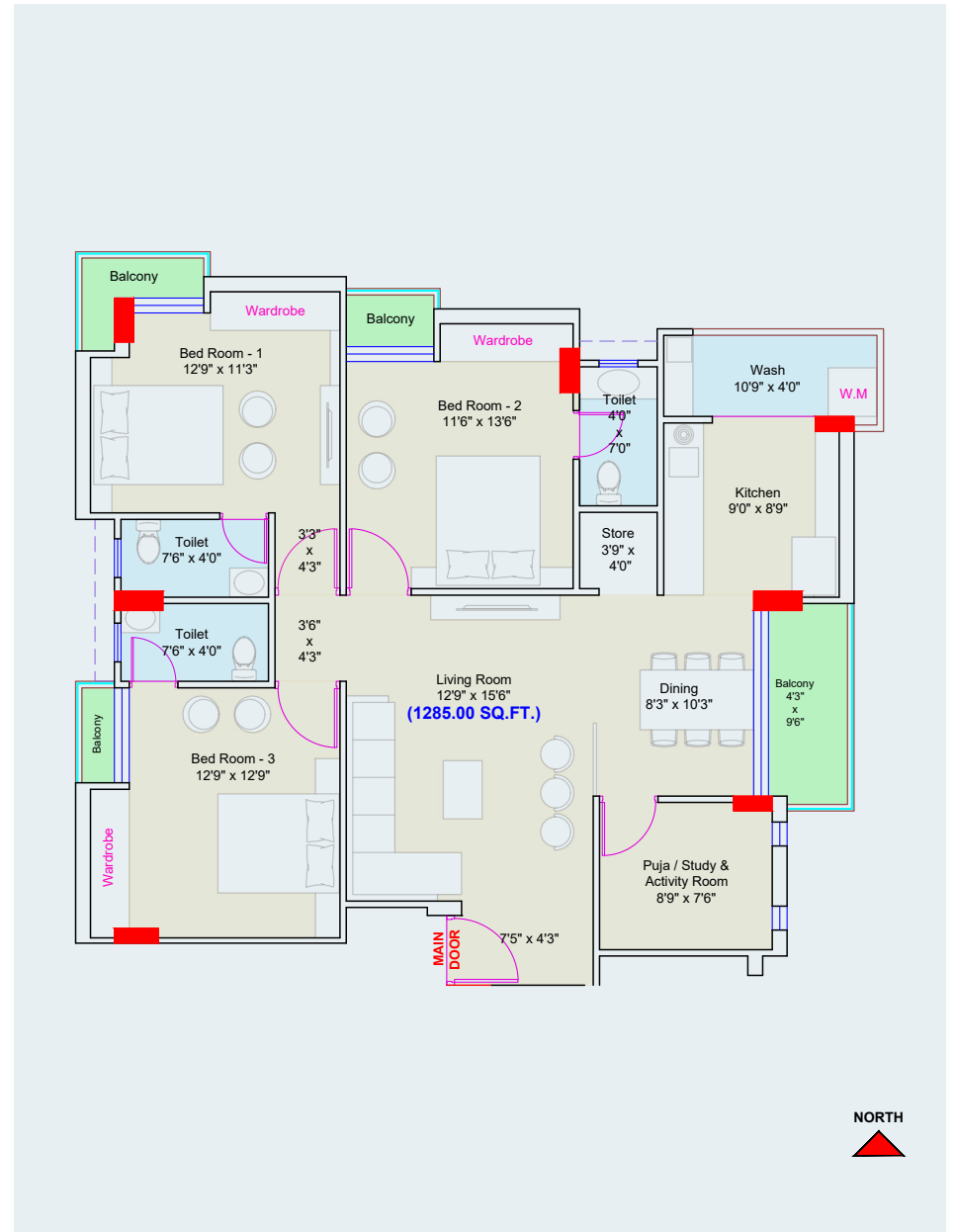

Rear Side Planning (Type - B) **1285.00 sq.ft.**





Shree VasuPujya Avenue

Luxury 3.5 BHK Residences

Project By :

Khimjibhai Jogarana , Yash Rathod , Yash Udani

Planning & Designing : Ravi Sureliya

Structural Engineer : Ashwinbhai Lodhiya

Address : Gulab Nagar, Behind Swaminarayan Temple, Kalawad Road, Rajkot